



# ARBORICULTURAL REPORT AND SAFETY SURVEY

**Client:** Colwich Parish Council  
**Site:** Colwich Parish Centre  
Colwich Parish Allotments  
Colwich Jubilee Playing Fields

**Date:** 14 February 2019

**Ref.:** THL-R19-11

GROWING SINCE • 1982

**TREE HERITAGE**

Tree Heritage Ltd, 100 North Street, Leek, Staffordshire, ST13 8DQ  
Telephone: 01538 384019 • [treeheritage.co.uk](http://treeheritage.co.uk) • [info@treeheritage.co.uk](mailto:info@treeheritage.co.uk)



Registered in Wales: No. 1655803 Ford House, Market Place, Leek, Staffordshire, ST13 6JA VAT No: 368064436



## **CONTENTS**

- 1.0 Introduction
- 2.0 Limitations of report
- 3.0 Survey method
- 4.0 Arboricultural methods
- 5.0 Wildlife: timing of operations
- 6.0 Legal considerations
- 7.0 Overall considerations

Appendix A: Tree Survey Schedule

Appendix B: Tree Location Plan



## **1.0 Introduction**

- 1.1 The purpose of this report is to aid the management of the tree population on the above site. It identifies the condition of the trees and prescribes any work that is required based on the grounds of safety. It may also give recommendations for remedial work that may be desirable in order to keep or improve the quality of the trees.
- 1.2 All trees included in the survey are listed in the Tree Schedule in appendix A and identified on the Tree Location Plan in appendix B.
- 1.3 The site visit was on 12 February 2019. Surveyor: Ben Williams. The weather conditions: Clear and dry.

## **2.0 Limitations of report**

- 2.1 This report and survey are for tree safety and management purposes only. This report should not be used for other purposes such as planning applications.
- 2.2 The trees were inspected from ground level only and no invasive tools were used.
- 2.3 Due to the changing nature of trees the report is valid for a period of 12 months for the condition and 2 years for all other data.
- 2.4 Trees may affect buildings by indirect influence of their roots on the substrate on which structures are built and by direct action on foundations, drains and other underground services. This report does not attempt to address these issues.
- 2.5 Trees are dynamic structures that can change rapidly and can never be guaranteed 100% safe: even if they were deemed safe on the day of the inspection, they can sometimes suffer damage in adverse weather conditions. All trees should be inspected following any bad weather.



### **3.0 Survey Method**

3.1 The survey was undertaken from ground level and includes all individual significant trees shown in position and numbered on the site plan. Some trees or sapling trees may be grouped together as numbered groups e.g. G1. The following information is collected and given in a schedule;

- Number
- Tree Species (Common Name)
- Age class (Young, Semi-Mature, Early-Mature, Mature, Over mature and Veteran)
- Size
- Height in metres
- Physiological Condition (Good, Fair, Poor or Dead). This is an overall assessment of the health of the tree based on leaf size, colour, density, annual growth increments and die-back or dead wood.
- Structural Condition (comments on decay, cavities, disease and other defects and issues that will affect its suitability for retention).
- Recommendations (These are based on the previous two categories and may include pruning or removal amongst other recommendations).
- Priority (Gives an indication of timescales)

### **4.0 Arboricultural Methods**

- 4.1 All tree work should be carried out by highly skilled professionals and it is recommended that contractors are selected from the Approved List of Arboricultural Association Contractors. This is obtained from [www.trees.org.uk](http://www.trees.org.uk)
- 4.2 All tree work should be carried out to the latest standards based on BS 3998: 2010 'Recommendations for Tree Work'.



## 5.0 Wildlife and Timing of Operations

- 5.1 Many animals including bats and birds are given special protection under the Wildlife and Countryside Act 1981(as amended) and the Countryside and Rights of Way Act 2001 amongst other legislation.
- 5.2 **Bats.** It is an offence to “intentionally or recklessly disturb a bat” or “damage, destroy or block the access to the resting place of any bat”. An assessment of trees on the site for “suitability for bats” is an essential part of the pre-planning stage. If bats are found or even reported to have used the trees for roosts then it is essential that a specialist in this field is contacted for advice. Natural England should be contacted on 0300 060 6000 or through [www.naturalengland.org.uk](http://www.naturalengland.org.uk) for details of suitable specialists. It may be that a European Protected Species Habitat Regulations Licence is required before work can continue. Following advice it is usual that work to trees with potential for bat roosts is best done from late August to early October. March through to April is also suitable but there may be conflict with nesting birds. (see below)
- 5.3 **Birds.** It is an offence to disturb, injure or kill any bird whilst it is at or building a nest. This includes damage to or removal of the actual nest whilst it is in use or being built. Tree works that could lead to the above should therefore be avoided during the months of late March through until August.
- 5.4 To avoid problems with either it would be advisable to programme all necessary site clearance work and tree pruning during August to late October.

## 6.0 Legal Considerations

- 6.1 Trees may be protected by a TPO (Tree Preservation Order) or Conservation Area.
- 6.2 In a Conservation Area it is a requirement to give Six Weeks Written Notice of any intended works. In the case of a TPO an application is required to the LPA on a 1APP form; in this case it may take 8-10 weeks before permission is given. It should be noted that permission is not required from the LPA to remove “Dead or Dangerous” trees although it is always best to inform the LPA of your intentions and supply suitable evidence to support your actions.



## **7.0 Overall Considerations**

### **7.1 Jubilee Playing Fields**

7.2 A total of 40 individual trees and 1 hedgerow were included in the survey. All trees and hedges are listed in the schedule and shown on plan THL-0734-1 attached to this report.

7.3 Most of the trees on site are in fair to good condition and only require basic maintenance such as crown lifting and removal of deadwood. Specific recommendations, and an indication of timescale, for each individual tree is included in the tree schedule.

7.4 Several of the trees are covered in ivy making inspection of the base and stem difficult. Some of these trees are located just beyond the boundary on neighbouring land. It is recommended that the ivy is severed at the base making re-inspection easier. For further details please see the tree survey schedule attached.

### **7.5 Allotments**

7.6 A total of 32 trees were included in the survey. All trees are listed in the survey schedule and shown on plan THL-0734-2 attached to this report.

7.7 All the mature trees located adjacent to the Coley Lane, and the mature trees located at the far end of the site, were individually tagged. The smaller trees located within the individual allotments were inspected, but not tagged due to their small size and risk of damaging the stems.

7.8 As with the playing field site, the work on this site is mainly deadwood removal and severing ivy.



## 7.9 **Parish Centre**

7.10 A total of 2 trees were included in the survey of this site. The trees are listed in the schedule and shown on plan THL-0734-3.

7.11 No work is required on this site at this stage.

7.12 Re-inspections and tree survey updates are best carried out at different times of the year so the trees can be seen in both Summer and Winter months. It is recommended that the next inspection of all 3 sites is carried out during the Summer months.

Tree Heritage Ltd

*Ben Williams*

Ben Williams  
BSc (Hons) Arb. M.Arbor.A

14 February 2019



## TREE SAFETY SURVEY

**KEY:**

Age Class	Size	Physiological Condition	Priority	Symbols
Y - Young SM - Semi-Mature EM - Early-Mature M - Mature OM - Over-Mature V - Veteran	S - Small M - Medium L - Large VL - Very Large	G - Good F - Fair P - Poor D - Dead	1 - Within 12 Months 2 - Within 6 Months 3 - Within 3 Months 4 - Within 1 Months 5 - Urgent Within 24 Hours	< - Less than ~ - Approximately > - Greater than



Tree Ref.	Species	Age Class	Size	Phys. Condition	Condition	Recommendations	Priority
T1724	Acer campestre (Field Maple)	M	M	Good	Low crown over footpath. Low crown over car park.	Crown lift to 3m.	1
T1725	Castanea sativa (Sweet Chestnut)	EM	M	Good	Major deadwood in crown. Poor pruning cuts.	Remove major deadwood. Remove stumps.	1
T1726	Fraxinus excelsior (Ash)	EM	M	Good	Major deadwood in crown. Low crown over footpath.	Remove major deadwood. Crown lift to 3m over footpath.	1
T1727	Fagus sylvatica (Beech)	SM	S	Good	Leaning South-West. Crown distorted due to group pressure. Low crown over road. Low crown over footpath.	Crown lift to 4m.	2
T1728	Prunus padus (Bird Cherry)	EM	S	Poor	Decay present at base. Cavity at base. Low crown over road.	Fell on the grounds of safety.	2
T1729	Prunus avium (Wild Cherry)	M	M	Fair		No work required.	
T1730	Prunus padus (Bird Cherry)	EM	S	Fair	Broken branches in crown.	Remove stumps.	1
T1731	Prunus padus (Bird Cherry)	EM	M	Fair	Major deadwood in crown. Poor pruning cuts.	Remove major deadwood. Remove stumps.	1
T1732	Quercus robur (Common Oak)	EM	S	Fair	Unbalanced crown shape.	No work required.	
T1733	Prunus padus (Bird Cherry)	EM	M	Fair	Crown distorted due to group pressure.	No work required.	
T1734	Prunus padus (Bird Cherry)	M	L	Fair	Unbalanced crown shape. Crown distorted due to group pressure. Low crown over car park.	Crown lift to 5m over car park.	1
T1735	Prunus padus (Bird Cherry)	M	L	Fair	Ivy on tree. Unbalanced crown shape. Crown distorted due to group pressure.	Sever Ivy.	1
T1736	Sorbus aucuparia (Rowan)	EM	S	Fair	Ivy on tree.	No work required.	
T1737	Fraxinus excelsior (Ash)	EM	M	Good	Low crown over car park.	Crown lift to 5m over car park.	1

Tree Ref.	Species	Age Class	Size	Phys. Condition	Condition	Recommendations	Priority
T1738	Prunus domestica (Damson)	EM	S	Good		No work required.	
T1739	Sambucus nigra (Elder)	M	S	Fair		No work required.	
H1740	Chamaecyparis lawsoniana (Lawson Cypress)	M	L	Good	Overgrown hedge.	No work required.	
T1741	Betula pendula (Silver Birch)	M	L	Good		No work required.	
T1742	Betula pendula (Silver Birch)	M	L	Good		No work required.	
T1743	Betula pendula (Silver Birch)	M	M	Fair	Tree located within neighbouring land. Leaning South. Tree heavily leaning into playing field.	Monitor. Re-inspect in 12months.	1
T1744	Prunus domestica (Damson)	EM	S	Fair	Poor shape & form.	No work required.	
T1745	Prunus domestica (Damson)	EM	S	Fair	Poor shape & form.	No work required.	
T1746	Aesculus hippocastanum (Horse Chestnut)	M	M	Poor	Low vitality. Declining. Tree located within neighbouring land. Broken branches in crown.	Monitor. Re-inspect in 12months.	1
T1747	Prunus avium (Wild Cherry)	M	M	Good	Unbalanced crown shape.	No work required.	
T1748	Prunus avium (Wild Cherry)	M	M	Good	Unbalanced crown shape.	No work required.	
T1749	Quercus robur (Common Oak)	M	L	Good		No work required.	
T1750	Quercus robur (Common Oak)	EM	M	Good	Poor shape & form.	No work required.	
T1751	Fraxinus excelsior (Ash)	EM	M	Good		No work required.	
T1752	Fraxinus excelsior (Ash)	EM	M	Good		No work required.	
T1753	Acer campestre (Field Maple)	EM	M	Good		No work required.	
T1754	Fraxinus excelsior (Ash)	EM	M	Good		No work required.	
T1755	Quercus robur (Common Oak)	M	M	Good		No work required.	

Tree Ref.	Species	Age Class	Size	Phys. Condition	Condition	Recommendations	Priority
T1756	Quercus robur (Common Oak)	EM	M	Good		No work required.	
T1757	Betula pendula (Silver Birch)	SM	S	Poor	Poor shape & form. Low vitality. Decay present on stem.	Remove tree.	1
T1758	Fraxinus excelsior (Ash)	M	L	Fair	Tree located within neighbouring land. Ivy on tree. Unable to inspect stem due to Ivy.	Monitor. Re-inspect in 12months.	1
T1759	Fraxinus excelsior (Ash)	M	VL	Fair	Tree located within neighbouring land. Ivy on tree. Unable to inspect stem due to Ivy. Major deadwood in crown.	Monitor. Re-inspect in 12months. Remove major deadwood over site.	1
T1760	Acer pseudoplatanus (Sycamore)	M	VL	Good	Tree located within neighbouring land. Major deadwood over site. Multi-stemmed.	Remove major deadwood over site.	1
T1761	Fraxinus excelsior (Ash)	M	VL	Fair	Tree located within neighbouring land. Ivy on tree. Unable to inspect stem due to Ivy. Low crown over site.	Sever Ivy. Crown lift to 5m.	1
T1762	Acer pseudoplatanus (Sycamore)	EM	M	Fair	Poor shape & form. Cavity on stem.	Remove tree.	1
T1763	Fraxinus excelsior (Ash)	M	VL	Fair	Ivy on tree. Unable to inspect stem due to Ivy.	Sever Ivy. Carry out further Inspection.	2
T1764	Fraxinus excelsior (Ash)	M	L	Fair	Ivy on tree. Unable to inspect stem due to Ivy.	Sever Ivy. Carry out further Inspection.	2

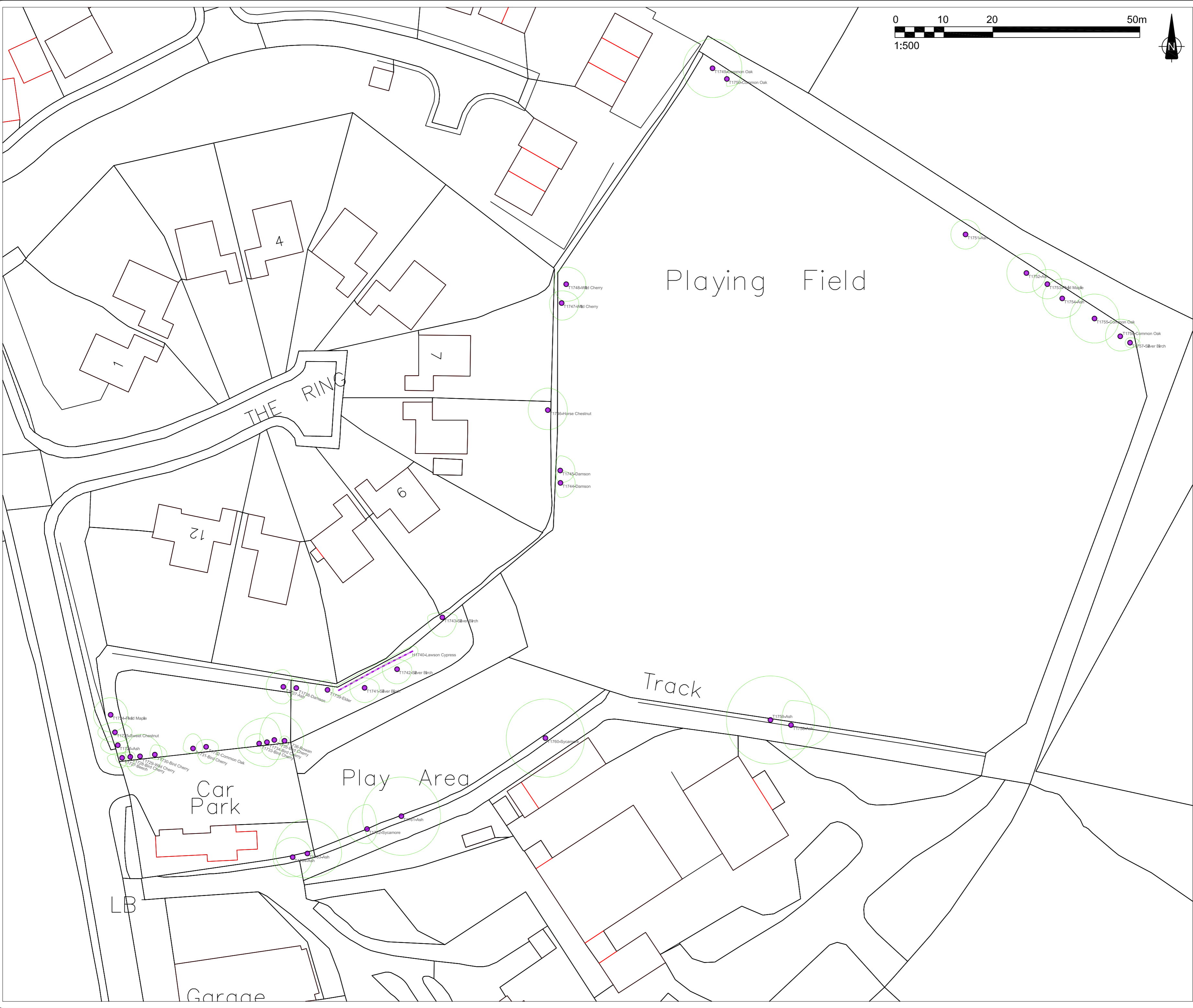

**Notes:**

- Contractors are advised to check all dimensions against the tree schedule. Tree canopies are symbolic only and are representative of the average spread; this may not represent the true outline. Note that the tree stem may not sit centrally to canopy. Tree stems are symbolic only and are representative of the tree category; this does not represent the stem diameter - see schedule for details.
- The original of this drawing was produced in colour - a monochrome copy should not be relied upon.

Rev:	Date:	Status/Amendments:	By:

**Key:**

- Tree
- Group

GROWING SINCE 1982

**TREE HERITAGE**

Tree Heritage Ltd, 100 North Street,  
Leek, Staffordshire, ST13 8DQ

Telephone: 01538 384019

treeheritage.co.uk • info@treeheritage.co.uk

Client:  
Colwich Parish Council

Project:  
Jubilee Playing Field

Drawing Title:  
Tree Location Plan

Scale: 1:500	Paper Size: A2
Drawing Number: THL-0734-1	Date Created: 12/02/19



## TREE SAFETY SURVEY

**KEY:**

Age Class	Size	Physiological Condition	Priority	Symbols
Y - Young SM - Semi-Mature EM - Early-Mature M - Mature OM - Over-Mature V - Veteran	S - Small M - Medium L - Large VL - Very Large	G - Good F - Fair P - Poor D - Dead	1 - Within 12 Months 2 - Within 6 Months 3 - Within 3 Months 4 - Within 1 Months 5 - Urgent Within 24 Hours	< - Less than ~ - Approximately > - Greater than

Tree Ref.	Species	Age Class	Size	Phys. Condition	Condition	Recommendations	Priority
T1765	Quercus robur (Common Oak)	M	L	Good	Tree located within neighbouring land. Major deadwood in crown.	No work required.	
T1766	Acer campestre (Field Maple), Crataegus monogyna (Hawthorn), Fraxinus excelsior (Ash)	EM	M	Fair	Tree located within neighbouring land. Major deadwood in crown. Mixed group.	Remove major deadwood over road.	1
T1767	Quercus robur (Common Oak)	V	L	Good	Cavity on stem. Major deadwood in crown.	Remove major deadwood.	1
T1768	Quercus robur (Common Oak)	SM	S	Good		No work required.	
T1769	Quercus robur (Common Oak)	M	L	Good	Major deadwood in crown.	Remove major deadwood.	1
T1770	Quercus robur (Common Oak)	M	L	Good	Ivy on tree. Major deadwood in crown.	Remove major deadwood.	1
T1771	Quercus robur (Common Oak)	M	L	Good	Ivy on tree.	No work required.	
T1772	Quercus robur (Common Oak)	M	L	Good	Ivy on tree. Poor pruning cuts.	No work required.	
T1773	Acer campestre (Field Maple)	M	L	Fair	Ivy on tree. Large break out wound on stem.	Re-inspect in 12months. Sever Ivy.	1
T1774	Quercus robur (Common Oak)	M	L	Fair	Poor shape & form. Ivy on tree. Poor pruning cuts.	No work required.	
T1775	Fraxinus excelsior (Ash)	SM	S	Good	Leaning over road.	No work required.	
T1776	Prunus avium (Wild Cherry)	SM	S	Good	Group of small trees.	No work required.	
T1777	Fraxinus excelsior (Ash)	M	L	Fair	Poor shape & form. Tree located within neighbouring land. Ivy on tree.	No work required.	
T1778	Prunus avium (Wild Cherry)	SM	S	Good		No work required.	
T1779	Fraxinus excelsior (Ash)	M	L	Fair	Low vitality. Major deadwood in crown.	Monitor. Remove major deadwood.	2

Tree Ref.	Species	Age Class	Size	Phys. Condition	Condition	Recommendations	Priority
T1780	Quercus robur (Common Oak)	M	L	Good	Ivy on tree. Hanging branches in crown. Broken branches in crown. Major deadwood in crown.	Remove major deadwood. Remove broken/damaged branches. Remove hanging branches.	2
T1781	Quercus robur (Common Oak)	M	L	Good	Ivy on tree. Major deadwood in crown.	Remove major deadwood.	1
T1782	Prunus avium (Wild Cherry)	EM	S	Fair	Ivy on tree. Stake and tie damaging base.	Sever Ivy. Remove stake and tie.	1
T1783	Fraxinus excelsior (Ash)	M	L	Good	Ivy on tree. Major deadwood in crown.	Sever Ivy. Remove major deadwood.	1
T1784	Prunus avium (Wild Cherry)	M	M	Fair	Ivy on tree. Unbalanced crown shape.	Sever Ivy.	1
T1785	Prunus avium (Wild Cherry)	M	M	Fair	Ivy on tree.	No work required.	
T1786	Prunus avium (Wild Cherry)	EM	M	Good	Ivy on tree.	Sever Ivy.	
T1787	Ilex aquifolium (Holly)	M	M	Good		No work required.	
T1788	Sambucus nigra (Elder)	M	M	Fair	Ivy on tree.	No work required.	
T1789	Ilex aquifolium (Holly)	M	M	Good		No work required.	
T1790	Malus sylvestris (Crab Apple)	M	M	Good		No work required.	
T1791	Malus sylvestris (Crab Apple)	M	S	Good		No work required.	
T1792	Sambucus nigra (Elder)	EM	S	Fair		No work required.	
T1793	Fraxinus excelsior (Ash)	M	VL	Fair	Tree located within neighbouring land. Ivy on tree. Major deadwood in crown.	Remove major deadwood over site.	1
T1794	Quercus robur (Common Oak)	M	VL	Good	Hanging branches in crown. Major deadwood in crown.	Remove major deadwood over site. Remove hanging branches.	1
T1795	Quercus robur (Common Oak)	M	L	Good	Major deadwood in crown.	Remove major deadwood over site.	1
T1796	Pinus wallichiana (Bhutan Pine)	EM	L	Good		No work required.	



**Notes:**

- Contractors are advised to check all dimensions against the tree schedule. Tree canopies are symbolic only and are representative of the average spread; this may not represent the true outline. Note that the tree stem may not sit centrally to canopy. Tree stems are symbolic only and are representative of the tree category; this does not represent the stem diameter - see schedule for details.
- The original of this drawing was produced in colour - a monochrome copy should not be relied upon.

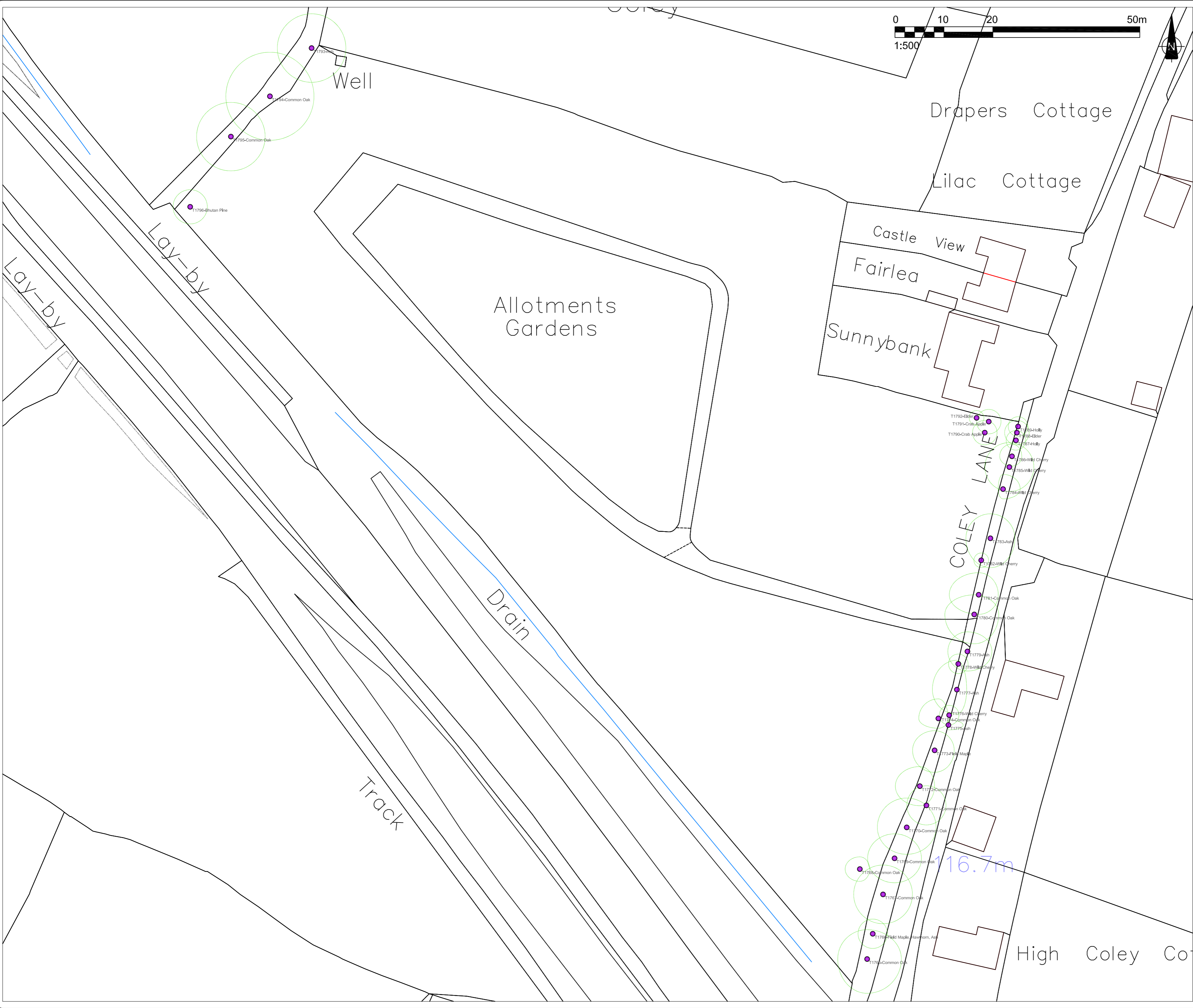
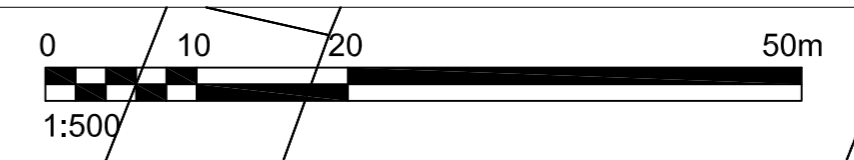

Rev:	Date:	Status/Amendments:	By:

**Key:**

- Tree
- Group

GROWING SINCE 1982

## TREE HERITAGE

Tree Heritage Ltd, 100 North Street,  
Leek, Staffordshire, ST13 8DQ

Telephone: 01538 384019

[treeheritage.co.uk](http://treeheritage.co.uk) • [info@treeheritage.co.uk](mailto:info@treeheritage.co.uk)

**Client:**  
Colwich Parish Council

**Project:**  
Allotments

**Drawing Title:**  
Tree Location Plan

<b>Scale:</b> 1:500	<b>Paper Size:</b> A2
<b>Drawing Number:</b> THL-0734-2	<b>Date Created:</b> 12/02/19





## TREE SAFETY SURVEY

**KEY:**

Age Class	Size	Physiological Condition	Priority	Symbols
Y - Young SM - Semi-Mature EM - Early-Mature M - Mature OM - Over-Mature V - Veteran	S - Small M - Medium L - Large VL - Very Large	G - Good F - Fair P - Poor D - Dead	1 - Within 12 Months 2 - Within 6 Months 3 - Within 3 Months 4 - Within 1 Months 5 - Urgent Within 24 Hours	< - Less than ~ - Approximately > - Greater than

Site: Colwich Parish Centre  
Surveyed by: Ben Williams BSc (Hons) Arb. M.Arbor.A  
Date: 12/02/19

Tree Heritage Ltd, 100 North St, Leek, Staffs, ST13 8DQ  
T: 01538 384019 E: info@treeheritage.co.uk

Tree Ref.	Species	Age Class	Size	Phys. Condition	Condition	Recommendations	Priority
T1797	Prunus serrulata (Japanese Flowering Cherry)	M	M	Good	Included bark present in fork.	No work required.	
T1798	Picea abies (Norway Spruce)	SM	M	Good		No work required.	

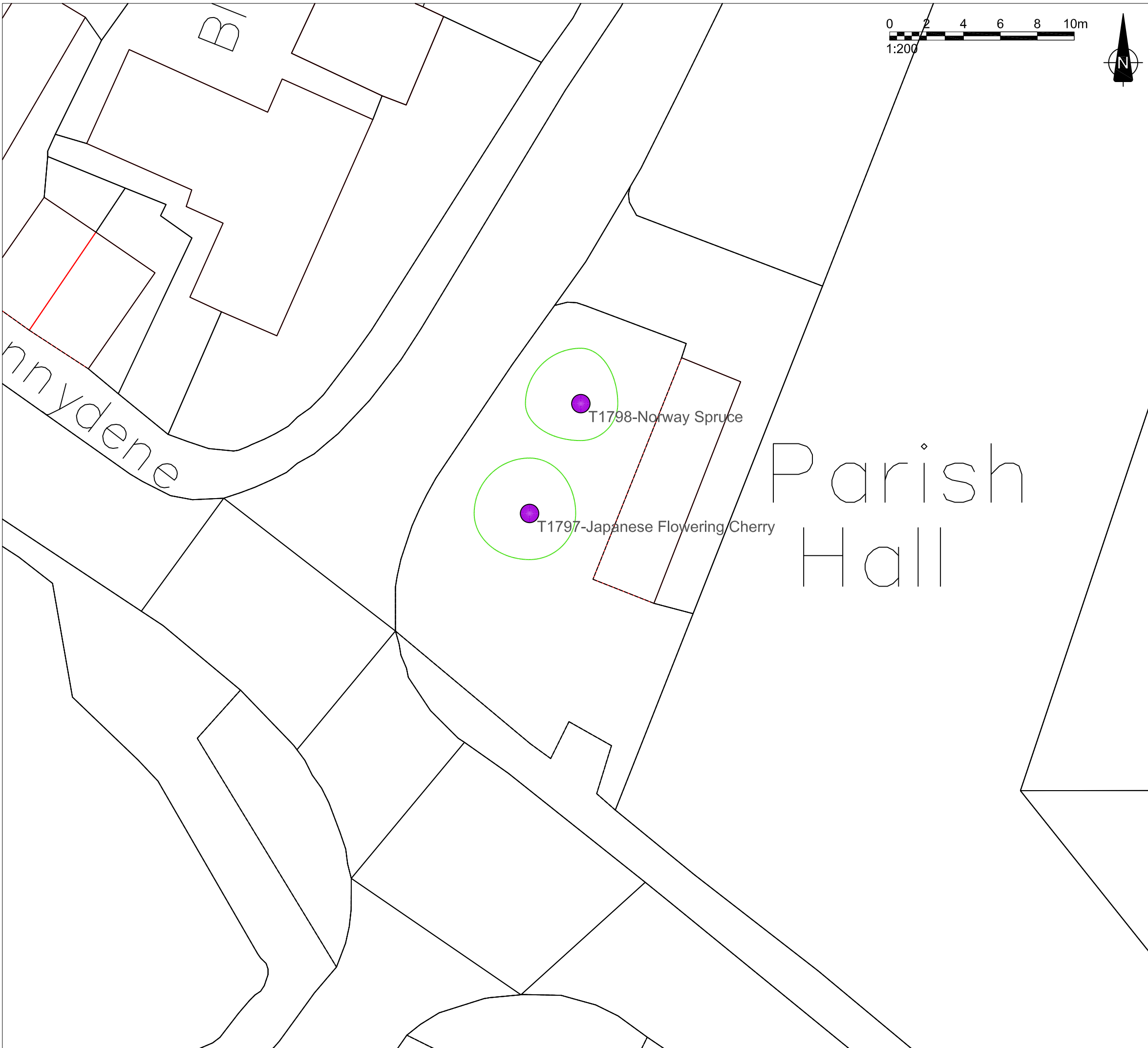

**Notes:**

- Contractors are advised to check all dimensions against the tree schedule. Tree canopies are symbolic only and are representative of the average spread; this may not represent the true outline. Note that the tree stem may not sit centrally to canopy. Tree stems are symbolic only and are representative of the tree category; this does not represent the stem diameter - see schedule for details.
- The original of this drawing was produced in colour - a monochrome copy should not be relied upon.

Rev:	Date:	Status/Amendments:	By:

**Key:**

- Tree
- Group

GROWING SINCE 1982

# TREE HERITAGE



Tree Heritage Ltd, 100 North Street,  
Leek, Staffordshire, ST13 8DQ

Telephone: 01538 384019

treeheritage.co.uk • info@treeheritage.co.uk

*Client:*

Colwich Parish Council

*Project:*

Parish Centre

*Drawing Title:*

Tree Location Plan

<i>Scale:</i>	1:200	<i>Paper Size:</i>	A3
<i>Drawing Number:</i>	THL-0734-3	<i>Date Created:</i>	12/02/19