

Cllr Dunn
Colwich Parish Council
Parish Office
St Marys Road
Little Haywood
ST18 0TX

26 April 2019

Dear Cllr Dunn

HIGH SPEED RAIL (WEST MIDLANDS – CREWE) BILL – ADDITIONAL PROVISION 2 - HOUSE OF COMMONS SELECT COMMITTEE: PETITION HS2-AP2-061 – COLWICH PARISH COUNCIL

I am writing to you in my capacity as the Director of Hybrid Bill Delivery at HS2 Ltd, which is acting on behalf of the Promoter of the High Speed Rail (West Midlands-Crewe) Bill ('the Bill') currently before Parliament. I understand that Colwich Parish Council has a number of concerns about the impact of the proposals in Additional Provision 2 (AP2) to the Bill in the House of Commons and has submitted a petition on that basis.

I understand my colleagues met with you on 11 April 2019 to discuss your petition and on 25 April to do a walk through the areas relating to your concerns over flooding.

I am writing to you, on behalf of the Secretary of State for Transport, to offer Colwich Parish Council the following assurances:

"Speed limit

The Secretary of State will require the nominated undertaker to engage with Staffordshire County Council in relation to the speed limit on the A51 Lichfield Road between Main Road Great Haywood and Church Lane Hixon and the possibility of a consistent speed limit on this road during the Authorised Works, noting that any decision to modify the speed limit on this road is a matter for Staffordshire County Council.

Flooding

The Promoter will engage with the Lead Local Flood Authority during the detailed design of the Utility Compound with the aim of reducing the impact of the construction of the Utility Compound on flood risk in the surrounding area as far as reasonably practicable

In this assurance:-

“Lead Local Flood Authority” means Staffordshire County Council or any successor body which takes over such statutory functions for local flood management for the area; and

“Utility Compound” means Main Road Utility Compound as shown on the attached plan (CT-05-212).

Reducing run-off rates

1.1 During the detailed design of the drainage infrastructure of the Proposed Scheme within the Parish of Colwich the Secretary of State will require the nominated undertaker to use reasonable endeavours in the design of the infrastructure to provide for run-off rates and volumes below existing greenfield run-off rates currently discharged into the un-named watercourse illustrated indicatively on the attached plan (CT-06-212) as far as reasonably practicable.”

If accepted, these assurances will be included in the Register of Undertakings and Assurances, which is held by the Department for Transport. Drafts of the Register will be published regularly during the passage of the Bill and it will be finalised after Royal Assent. A nominated undertaker will be contractually obliged to comply with all relevant undertakings and assurances set out in the Register. The assurance process is set out in Annex A.

Additionally, I wrote to you on 2 April offering the following assurances:

Contractor vehicles

1.1 During the construction of the Proposed Scheme, the Secretary of State will require the nominated undertaker, in accordance with the COCP and the Information Paper, to:

1.1.1 clearly identify vehicles over 3.5 tonnes regularly employed on construction of the Proposed Scheme; and

1.1.2 ensure that heavy goods vehicle fleets used by Principal Contractors operate in accordance with an approved and audited fleet quality plan, such as but not limited to the

Signage

1.1 Subject to the conditions in paragraph 1.2 below, the Promoter will use reasonable endeavours to provide appropriate signage in relation to HS2 construction traffic at specific locations within the Parish Council Area.

1.2 The conditions referred to in paragraph 1.1 are:

1.2.1 that the Parish Council provides the Promoter with satisfactory information on the proposed location of the signage to allow the Promoter to consider whether the location is appropriate;

1.2.2 the Promoter agreeing that the proposed locations are suitable for such signage to be provided and having the necessary rights and consents to erect such signage at the location in question; and

1.2.3 the wording of the signage being agreed by the Promoter.

Reinstatement

Following the construction of the Proposed Scheme, the Secretary of State will require the nominated undertaker to use reasonable endeavours to reinstate the original road alignment of Great Haywood Road and surrounding hedgerows where Great Haywood Road is proposed to be temporarily widened by the Proposed Scheme as illustrated on Plan 1.

Highways Sub Group

The Promoter will ensure that, once a year, the Highways Sub Group meeting is widened to include both District and Parish Council representatives, with the agenda set by the invited authorities. The Councils to be invited will be nominated by the highway authorities along the line of route.

In addition, the Promoter will ensure that papers and minutes of both the Planning Forum and Highways Sub Group are published online and that the Parish Councils are able to request that matters of principle related to traffic, highways and transport matters during construction are addressed by the Highways Sub Group."

If you have any further queries please don't hesitate to contact Omar Deedat, Petition Advisor on 020 7944 8646 or omar.deedat@hs2.org.uk.

Yours sincerely



Oliver Bayne

Director, Hybrid Bill Delivery
High Speed Two (HS2) Limited

Annex A

ASSURANCES: STEPS AND TIMING

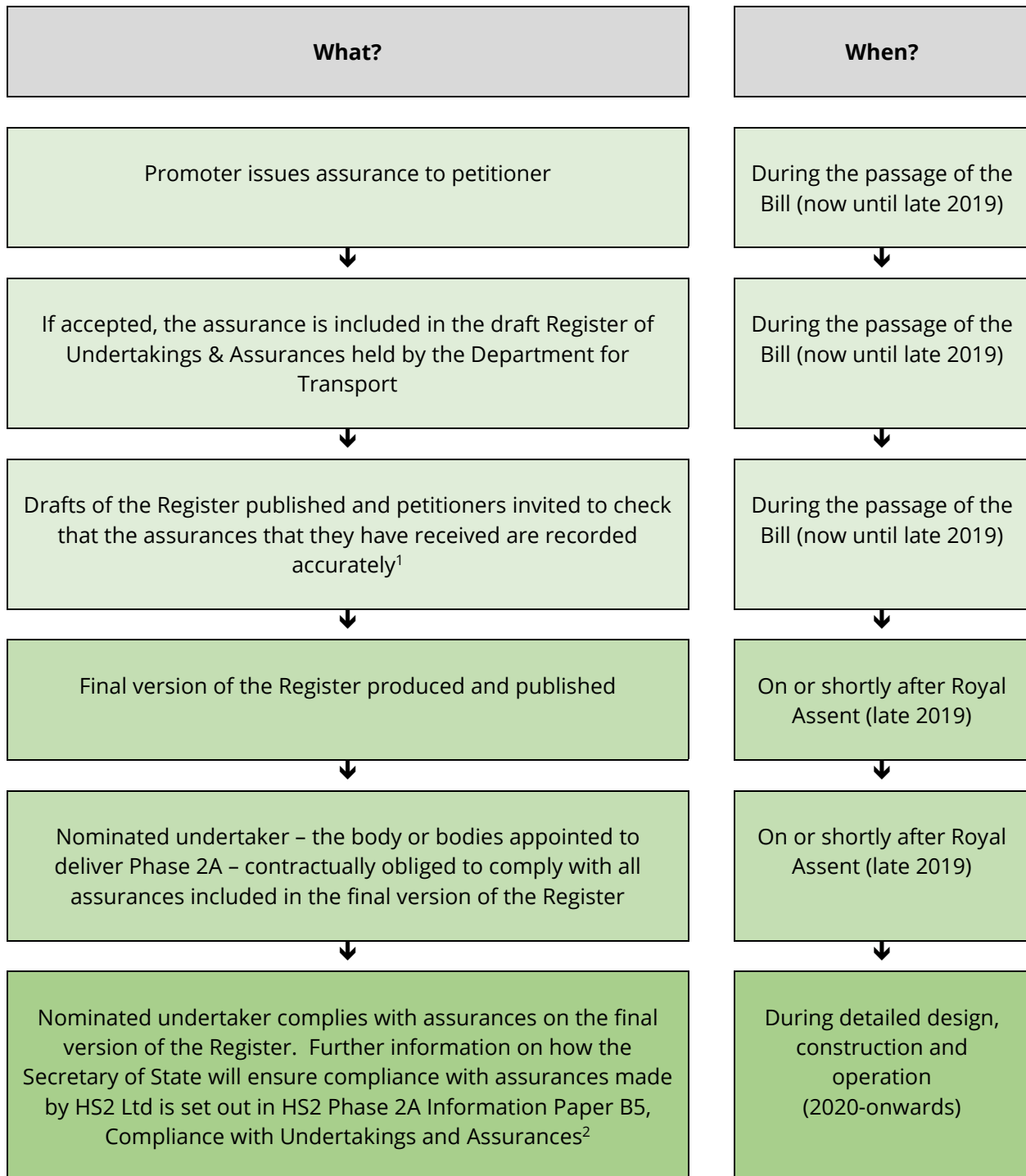

¹ The latest draft of the Register can be found at <https://www.gov.uk/government/publications/hs2-phase-2a-register-of-undertakings-and-assurances>

² A copy can be found at <https://www.gov.uk/government/publications/understanding-the-hybrid-bill-hs2-phase-2a-information-papers>

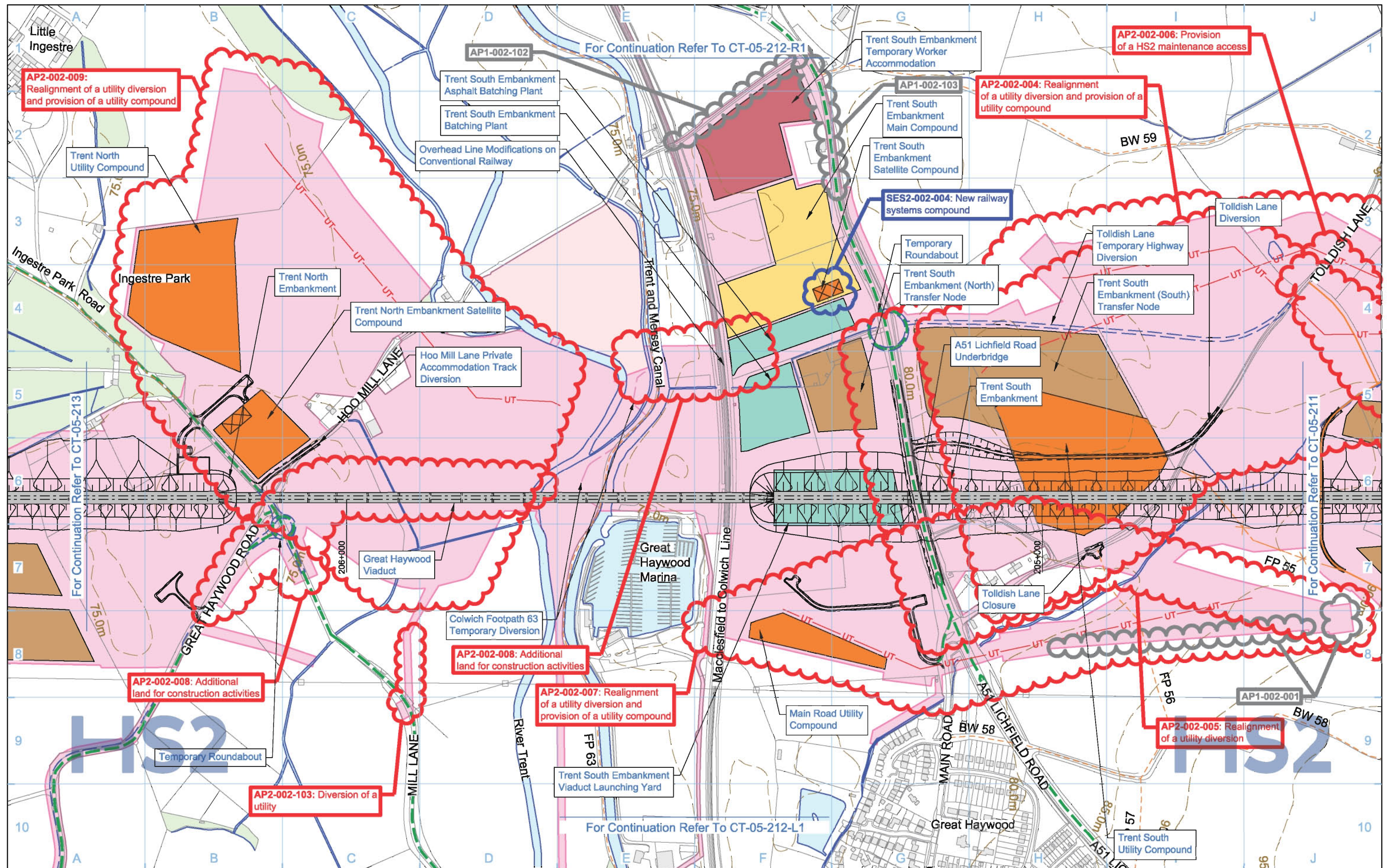

Legend Depot, station, headhouse or portal building Tunnel portal Main construction compound Satellite construction compound Railway systems compound Temporary material stockpile		Borrow Pit Storage / prefabrication / laydown areas Land potentially required during construction Extent of land potentially required during construction for mitigation planting Temporary replacement community facility		Community Area boundary Tunnels external extent Construction traffic route Existing Public Right of Way (PRoW) New, diverted or realigned PRoW Stopped-up PRoW Temporary PRoW diversion / realignment		Landscape earthworks Engineering earthworks Temporary highway diversion / realignment Main utility works Rail alignment Chainage (e.g. 10+000)		Existing woodland Existing buildings Existing inland water Existing watercourse Existing contours Rail alignment formation Temporary workers accommodation	
---	--	--	--	---	--	---	--	--	--

Map Number: **CT-05-212**

Map Name: **Construction Phase SES2 and AP2 ES**

Community Area: CA2 Colwich to Yarnet

HS2

Registered in England
Registration No. 06781686
Registered office:
2 Snow Hill, Queensway,
Birmingham, B4 6GA

Scale at A3: 1:5,000

0 50 100 150 200 250 Metres

Doc Number: 2PT02-ARP-EV-DPL-000-055212 P03 Date: 11/01/19

HS2 Ltd accept no responsibility for any circumstances, which arise from the reproduction of this map after alteration, amendment or abbreviation or if it is issued in part or issued incomplete in any way.

© Crown copyright and database rights 2018.
Ordnance Survey Licence Number 100049180.

